

From: [REDACTED]
To: [Norfolk Vanguard](#)
Subject: VES_1645_Happisburgh Cliff Comparison_Dec2018_1_1250@A1_2of2.pdf
Date: 15 January 2019 17:55:34
Attachments: [VES_1645_Happisburgh Cliff Comparison_Dec2018_1_1250@A1_2of2.pdf](#)

Part A of submission from Happisburgh PC 20012507
Copy of SMP 3b12 to follow

This email has been scanned by the Symantec Email Security.cloud service.
For more information please visit <http://www.symanteccloud.com>

Sent from my iPad

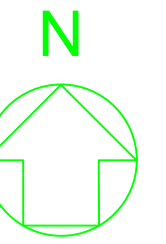

NOTE
This drawing must not be reissued, loaned or copied without the written consent of NPS Property Consultants Ltd. (the originator). All errors, omissions, discrepancies should be reported to the originator immediately.
All dimensions to be checked before site fabrication by the contractor, his sub-contractor or supplier.
Do not scale plans - use figure or grid dimensions where given. Any deviation from the drawing to be reported to the originator immediately.

© Crown Copyright and database rights 2017 Ordnance Survey 100019340

Legend

- OS Clifftop 2000
- December 2004
- December 2011
- August 2012
- November 2012
- March 2013
- June 2013
- November 2013
- August 2014
- June 2015
- January 2016
- March 2018
- August 2018
- December 2018

Notes:
All levels to Newlyn Datum (using OSGM15 transformation).

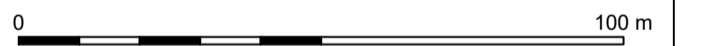

Rev	Date	Description

Drawing No.: VES 1645	Rev:
Project Name: Happisburgh Cliff Monitoring	
Drawing Title: December 2018	
Project Number: 01-02-18-2-1452	
Client: NNDC	
Surveyed by: CHF	
Drawn by: CHF	Checked by:
Date: Jan - 18	Scale: 1:1250 @ A1

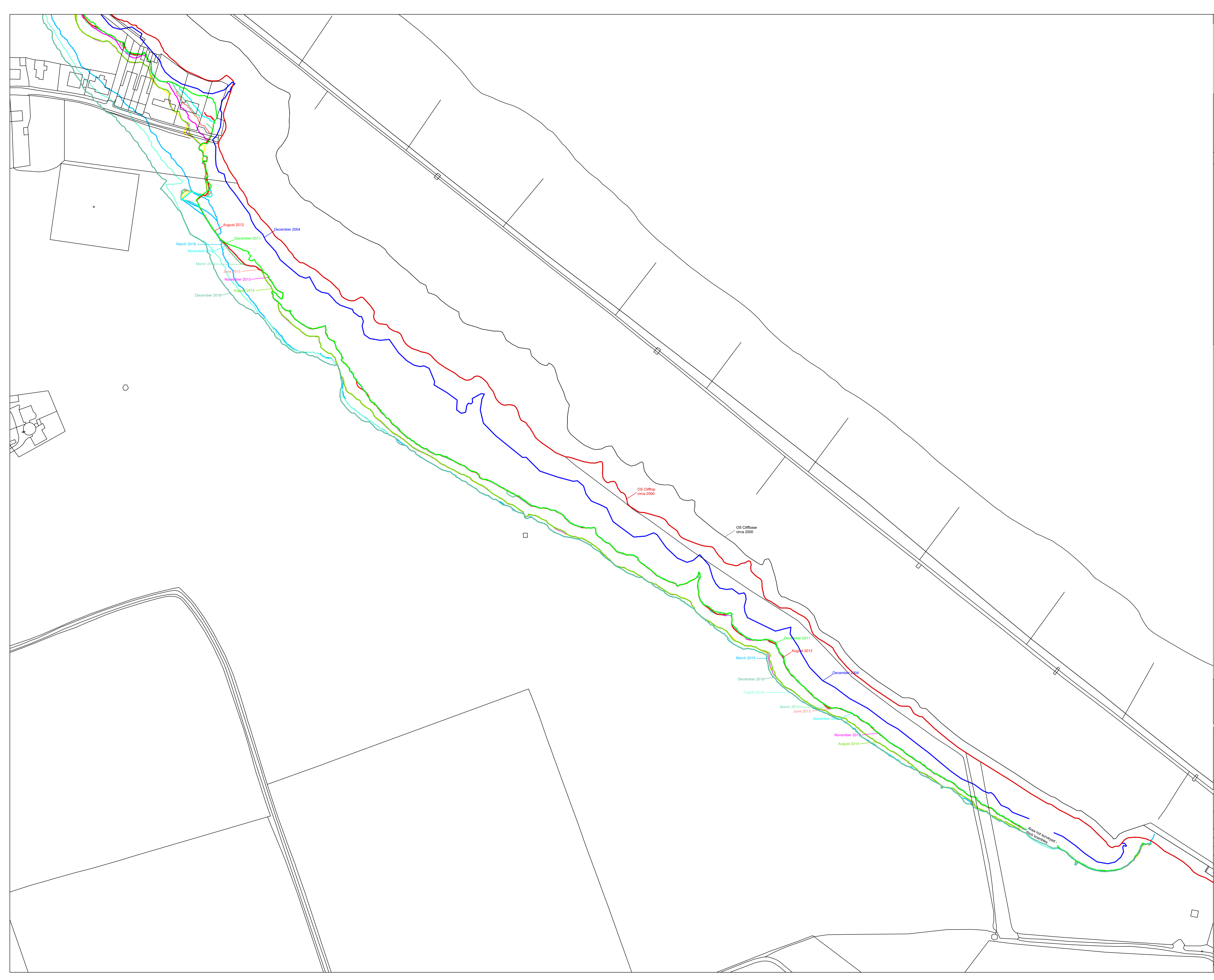

Part 5
 Grid Reference TG386307
 All beach users should proceed with caution when using the beach and sea.
 A seabed survey has been completed which reveals submerged debris below the high water mark.

The aerial has been scanned by the Geographic Grid Entry tool service.
 For more information please visit gls.norfolk.gov.uk

Happisburgh Beach

Grid Reference TG386307

All beach users should proceed with caution when using the beach and sea.
 A seabed survey has been completed which reveals submerged debris below the high water mark.

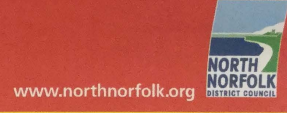

Caution

There is no lifeguard service operating

17/02/12

999 in an Emergency and ask for Coastguard
 An emergency phone is located at the entrance to the car park

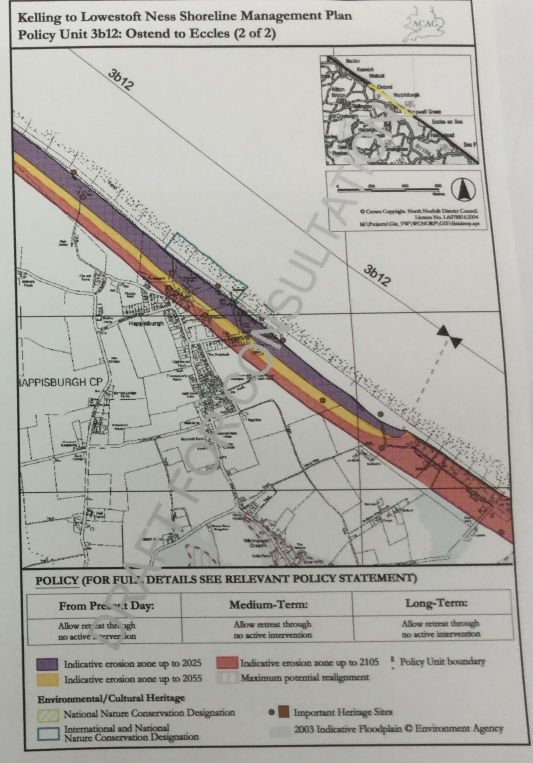
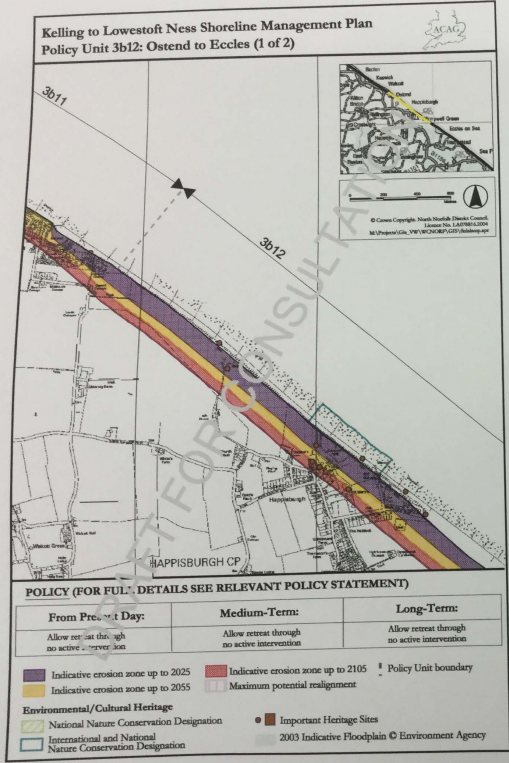

Location reference: Ostend to Eccles		Policy Unit reference: 3b12			
PREDICTED IMPLICATIONS OF THE PREFERRED PLAN FOR THIS LOCATION					
Time Period	Property & Land Use	Nature Conservation	Landscapes	Historic Environment	Amenity & Recreational Use
By 2007	Loss of less than one 18 properties (commercial and residential) along Beach Road, Happisburgh Loss of cliff top caravan park land at Happisburgh Loss of HLF (Coastguard Rescue facility) at Happisburgh Loss of Grade 1 agricultural land	Continued exposure of Happisburgh BSSB cliffs	No landscape objectives identified	No loss of cliff top heritage sites	Beach present, but probably less access to beach at Happisburgh
By 2050	Cumulative loss of between one and 30 properties (commercial and residential) along Beach Road, Happisburgh Further loss of cliff top caravan park land at Happisburgh Further loss of Grade 1 agricultural land	Continued exposure of Happisburgh BSSB cliffs	No landscape objectives identified	Loss of 18 Mary's church and Grade 1 agricultural sites at cliff erosion	Beach present, but probably less access to beach at Happisburgh
By 2100	Continued loss of between one and 30 properties (commercial and residential) along Beach Road, Happisburgh Loss of cliff top caravan park land at Happisburgh Loss of HLF (Coastguard Rescue facility) at Happisburgh Loss of Grade 1 agricultural land	Continued exposure of Happisburgh BSSB cliffs	No landscape objectives identified	Probable loss of Grade 1, B2 and Grade 2 agricultural sites at Mary's church	Beach present, but probably less access to beach at Happisburgh

Location reference: Ostend to Eccles
Policy Unit reference: 3b12

SUMMARY OF PREFERRED PLAN RECOMMENDATIONS AND JUSTIFICATION

Plan:
Although there are socio-economic implications, such as residential properties and amenities at risk from erosion at Happisburgh, these are not sufficient to economically justify building new defences along this frontage. Furthermore, it would not be appropriate to defend Happisburgh due to the impact this would have for the SMP shoreline as a whole, as the coastal retreat either side would result in the development of this area as a promontory making it both technically difficult to sustain and impacting significantly upon the alongshore sediment transport to downdrift areas. Therefore the proposed long-term Plan is to allow natural functioning of the coast through allowing it to retreat.

Preferred policies to implement Plan:
From present day: The preferred policy from the present day is to allow natural processes to take place, through not extending or seeking to replace existing defences, i.e. **no active intervention**. At Happisburgh the existing rock bund would continue to have a limited effect on the retreat rates in the short-term (next 5 to 10 years), but will not prevent cliff erosion. Therefore over this period there will be further loss of cliff top land, including Grade 1 agricultural land, and properties.

Medium-term: The medium-term policy is to allow coastal retreat with **no active intervention**, so that the cliff line reaches a more sustainable position, i.e. a more natural position. There will be continued loss of property and facilities during this time, therefore there needs to be continued management of this risk.

Long-term: In the long-term the preferred policy would be to allow coastal retreat, through **no active intervention**. During this period it is probable that properties threatened by erosion will include the village church. The increased throughput of sediment from adoption of similar policies to the north will help beaches to build along this frontage so that erosion, and therefore property loss, here is not accelerated over and above natural rates.

Once the shoreline reaches a more sustainable position, it may be acceptable to help beach retention at Happisburgh, if necessary, with structures such as short groyynes, provided that these are not detrimental to continued adequate sediment throughput to areas downdrift. These should not halt erosion, but would help to manage it in a sustainable manner.

The above provides the **local** details in respect of the SMP-wide Plan, therefore the above **must** be read in the context of the wider-scale issues and policy implications, as presented in the preceding sections and Appendices to this Plan document.



From: [Redacted]
To: [Redacted]
Subject: Submission from Haggisburgh PC 20012507
Date: 15 January 2019 11:58:18

Part D of submission from Haggisburgh PC 20012507

There is concern over the proposed closure for the duration of the project of this green line which has been used historically by ramblers, dog walkers and horse riders. It was pointed out to Vattenfall that they seemed to have lost the track of some of their consultation maps. By keeping this track open with a crossing place for VF which would only be the same as a road crossing 50m it will allow safe passage from one end of the village to the other for the public to avoid the barriers and traffic using the road ways to the landfill site. It should also be noted that on this map the cliff line has now eroded to almost a straight line in front of the landfill site please see photos sent as part E
Glenn Berry Haggisburgh PC

This email has been scanned by the Symantec Email Security.cloud service.
For more information please visit <http://www.symanteccloud.com>

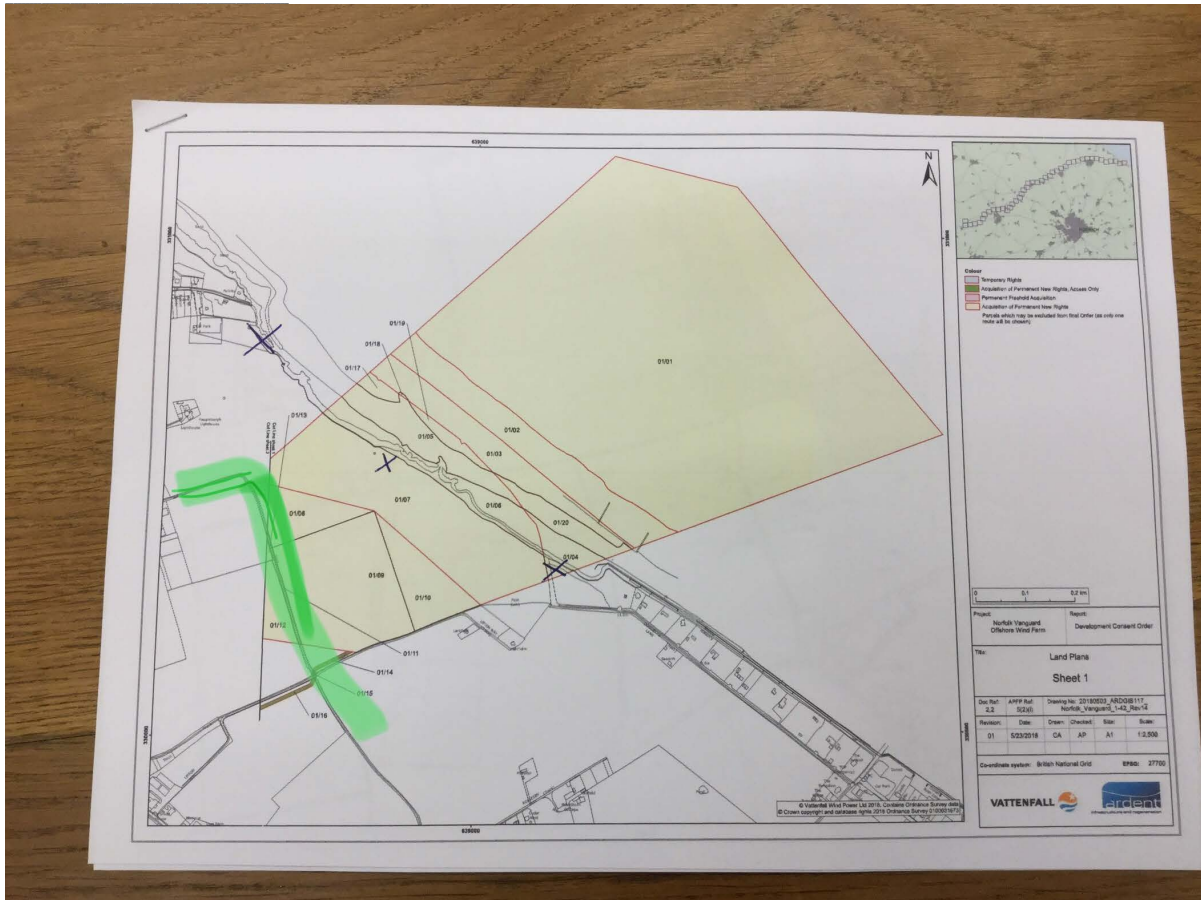

Sent from my iPad

Page: 1
Title: Beach
Date: 15 January 2015 10:22:25

Part 2: photo of beach in front of sand dune.
Beach dune dunes in front of car park was built with the help of the Footballer Project and was opened in 2012 and given to the village on a 25-year lease it was donated with for this amount of time but if needed the car park could be turned around to the other side of the hotel block. We are now in the process of having to do this but as the entrance to Brack Hill is now under threat we are having to look at a new entrance off Lighthouse Lane.
Beach dunes in front of car park.

This content has been scanned by the Singapore e-Read Security Check service.
For more information please visit: <https://www.e-read.gov.sg/>



Beach from my iPad